

Desks

- 1 Worktop** - 78mm thick, veneer/HPL, max. load 70 kg
- 2 Sliding front** - MDF, varnished 6/8" (18 mm), soft-closing system
- 3 Drawer** - 100% extraction, self-closing, dimensions: 11 3/8" (290 mm) x 19 5/8" (500 mm) x 11" (280 mm)
- 4 Body** - MDF lacquered 1 1/8" (28 mm)
- 5 OPTIONS WITH EXTRA CHARGE:**
 - **Mediabox M06** - 2x120V+USB charger, color: white or black
 - **Mediabox M06H** - 2x120V+HDMI+USB, colour: white or black
- 6 Control panel**
- 7 Electric height adjustable frame** - powder coated steel, column dimension 5 7/8" (150 mm) x 5 7/8" (150 mm), frame profile 2 3/8" (60 mm) x 1 1/8" (30 mm)
- 8 Shelf** - MFC 18 mm, dimensions: 457x182x259mm

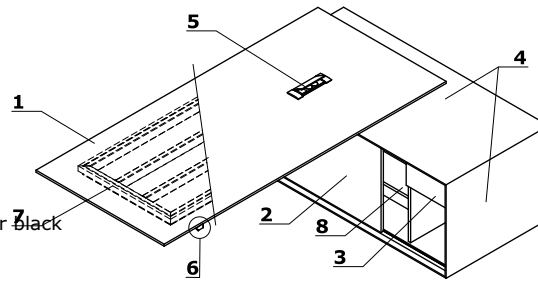

Inside the cabinet:

- 9 Usable space**
- 10 Structure space non - usable** - supporting structure + concrete blocks

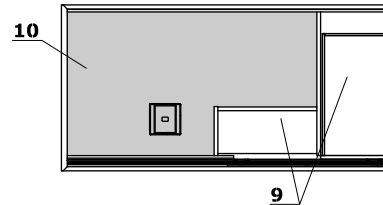

- 11 Lifting mechanism access**

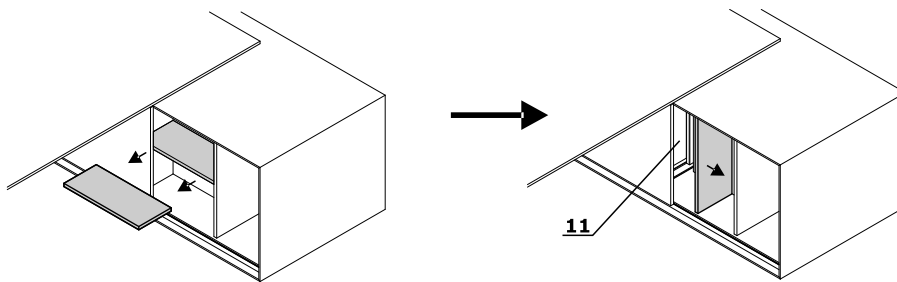

ATTENTION: Desk, table and multimedia stand require a hard and unbendable surface with acceptable point pressure of at least 300 kg/point in order to preserve stability.

Dimensions (inch/mm)

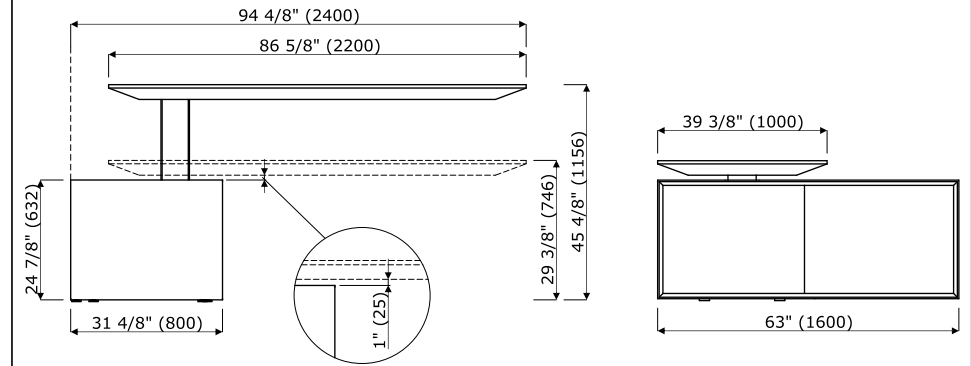

Mediabox location

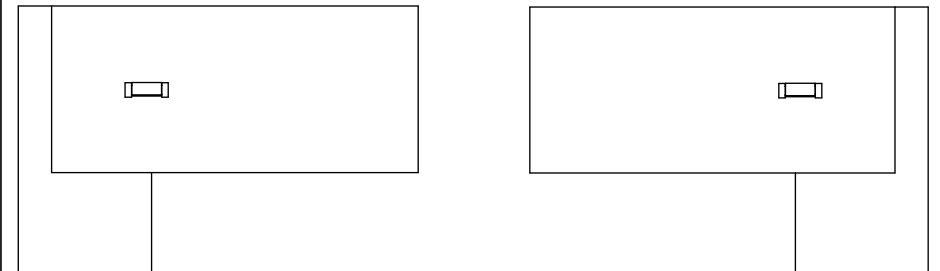

Multimedia stand with electric height adjustment

- 1 Worktop** - 78mm thick, veneer/HPL, max. load 70 kg
- 2 Control panel**
- 3 MEDIABOX** - 2x 230V + HDMI + USB, color: white or black
- 4 MEDIABOX** - 1x 230V + HDMI + USB, colour: white or black
- 5 Body** - MDF lacquered 1 1/8" (28 mm)
- 6 Handles** - VESA fixing, spacing 15 6/8" x 15 6/8" (400 x 400 mm), max weight of TV 40 kg, tilt adjustment - 10 degrees
- 7 Structure space non** - usable - supporting structure + concrete blocks

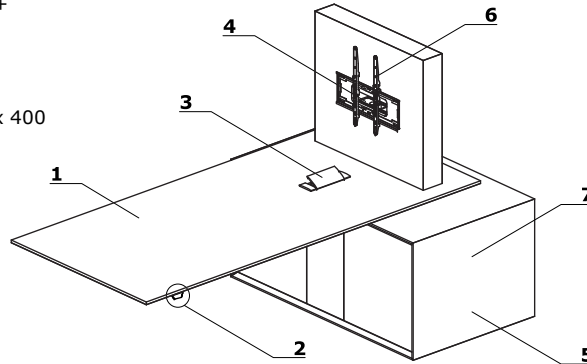

ATTENTION: Desk, table and multimedia stand require a hard and unbendable surface with acceptable point pressure of at least 300 kg/point in order to preserve stability.

Dimensions (inch/mm)

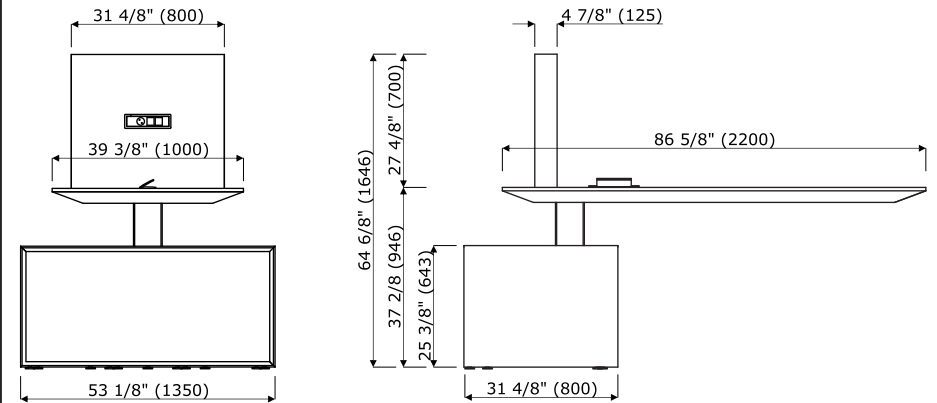

Conference tables with electric height adjustment

- 1 Worktop** - 78mm thick, veneer/HPL, max. load 70 kg
- 2 Control panel**
- 3 OPTIONS WITH EXTRA CHARGE:**
 - **Mediabox M06** - 2x120V+USB charger, color: white or black
 - **Mediabox M06H** - 2x120V+HDMI+USB, colour: white or black
- 4 Body** - MDF lacquered 1 1/8" (28 mm)
- 5 Structure space non** - usable - supporting structure + concrete blocks

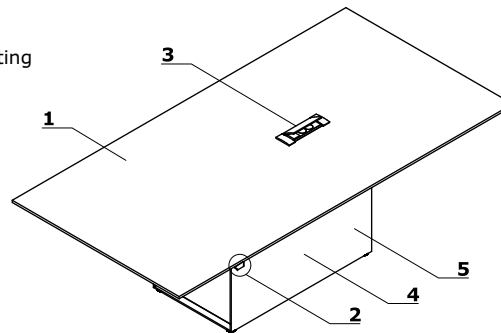

ATTENTION: Desk, table and multimedia stand require a hard and unbendable surface with acceptable point pressure of at least 300 kg/point in order to preserve stability.

Dimensions (inch/mm)

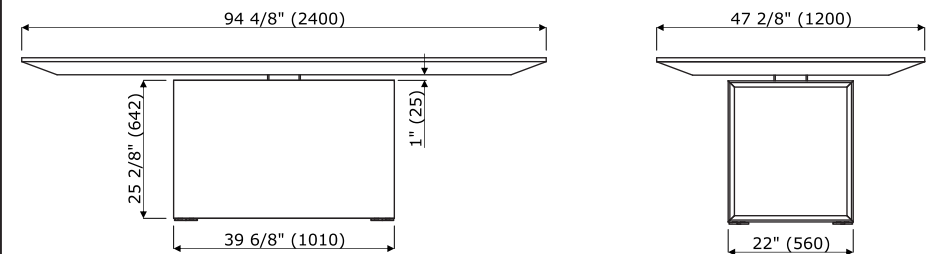

Control panel

1 Control panel

A - up and down keypad with memory; the ability to change the sensitivity of the anti-collision system within 3 levels: Low, Medium, High

B - OPTION WITH EXTRA CHARGE - bluetooth module:

- compatible with panel A
- the ability to change the sensitivity of the anti - collision system within 3 levels: Low, Medium, High
- control via .mdd Desk BT application (downloadable from Google Play or App Store). The app has a time interval function that informs the user about the need of changing body position (from sitting to standing or standing to sitting)

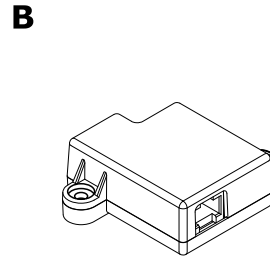
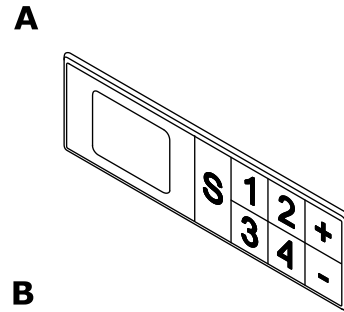

Frame technical specification

- **Height adjustment** - 1 5/8" (40 mm) /sec
- **Super Soft Start - Stop**
- **Drive** - 2 synchronised motors with microprocessor, work control sensor
- **ISP** - Intelligent System Protection
- **Standards** - EN 527-2
- **EU Directives 206/95EC, UI508 1999, UL 1004 R7 06, WE DC 2004/108WE**
- **Power supply** - 110V, 300W, power consumption on Standby - 0.3W

Conference table

- 1 Worktop** - 78mm thick, veneer/HPL, max. load 70 kg
- 2 OPTIONS WITH EXTRA CHARGE:**
 - **Mediabox M06** - 2x120V+USB charger, color: white or black
 - **Mediabox M06H** - 2x120V+HDMI+USB, colour: white or black
- 3 Body** - MDF lacquered 1 1/8" (28 mm)
- 4 Structure space non** - usable - supporting structure + concrete blocks

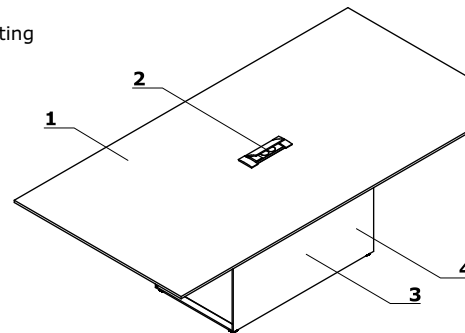

ATTENTION: Desk, table and multimedia stand require a hard and unbendable surface with acceptable point pressure of at least 300 kg/point in order to preserve stability.

Dimensions (inch/mm)

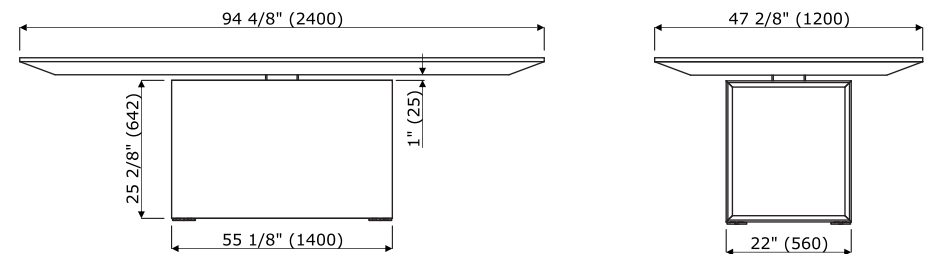

Cabinet and regal

- 1 Finish** - MDF, varnished 1 4/8" (38 mm)
- 2 Milled Surface**
- 3 Inside the cabinet** - dimensions : 29 1/8" (740 mm) x 13 6/8" (350 mm) x 15" (380 mm)
- 4 Drawer:**
 - dimensions: 27" (686 mm) x 7 2/8" (185 mm) x 13 6/8" (350 mm)
 - front - MDF, varnished/ veneer 1 4/8" (38 mm)
 - interior - MFC 6/8" (18 mm)

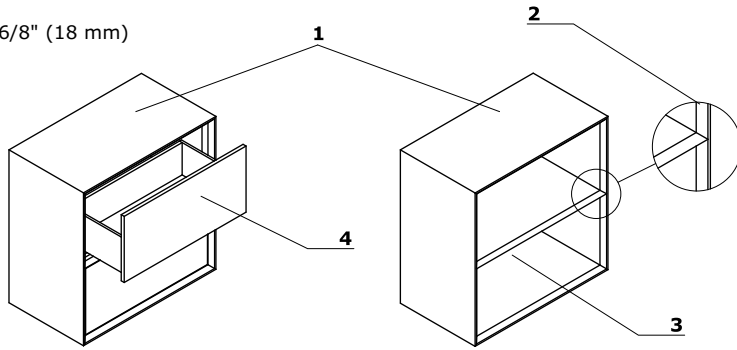
**Coffee table**

- 1 Finish** - MDF, varnished 1 4/8" (38 mm)
- 2 Inside** - dimensions of cabinet interior: 45" (1142 mm) x 11 4/8" (292 mm) x 18 2/8" (462 mm)

